

BLUSH

Office series



The Blush office is a playful and all-around furniture solution.

Because of their characteristic form and size they can easily be combined and be used for a variety of purposes.

The wooden inlay sits flush with the laminate tabletop. We offer the blush also in solid wood, laminate and laminate with black core surfaces without the inlay.

These tables feel right at home in a lobby area, library, work place, restaurant or any active room, making them look colourful, elegant and fun.

FIND ONLINE:

• CAD DATA

• COLOURS & MATERIALS

• HIGH RES. IMAGES

• TRADE & CUSTOM SOLUTIONS



BLUSH CONFERENCE



BLUSH OFFICE



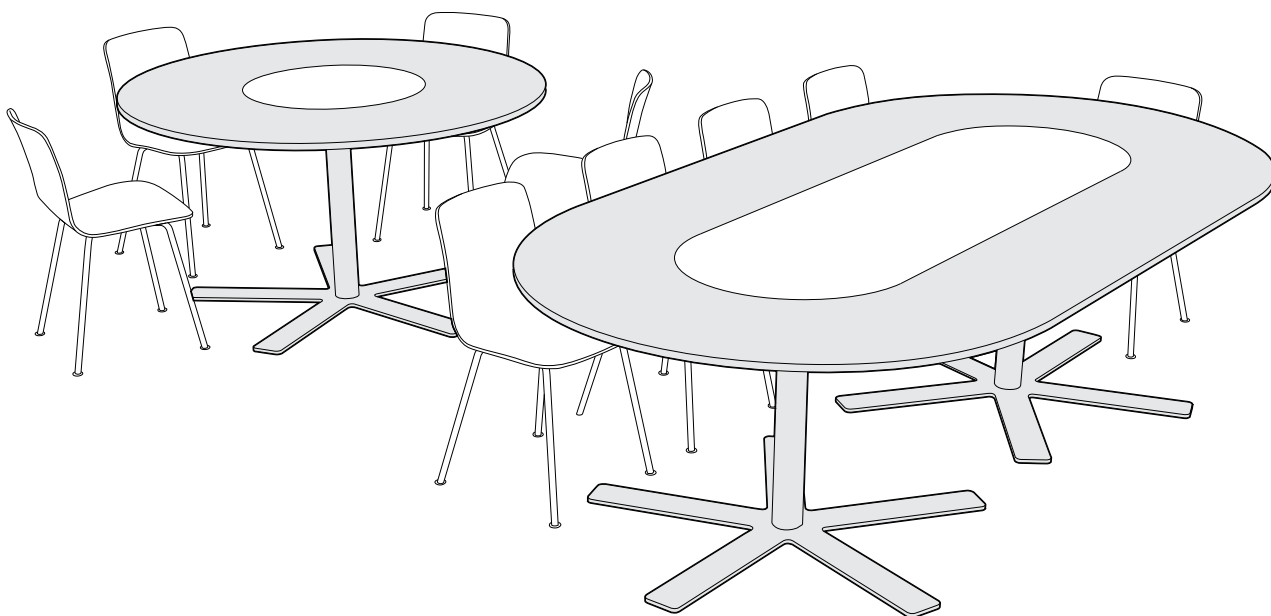

BLUSH OFFICE BOLD

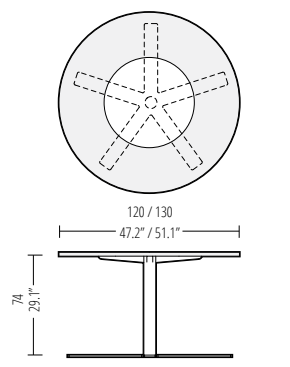

DIMENSIONS

TABLETOP - INLAY



-  WOOD / HPL
-  METAL

Blush 120 Conference

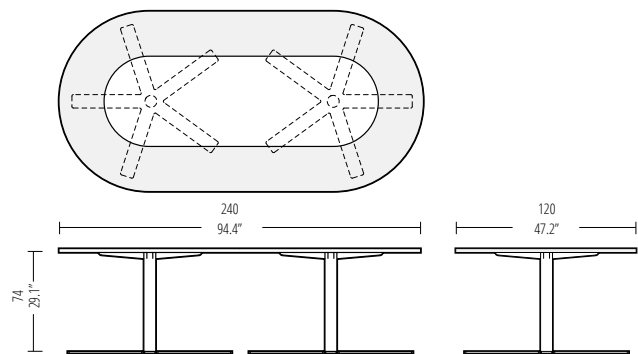

Blush Office

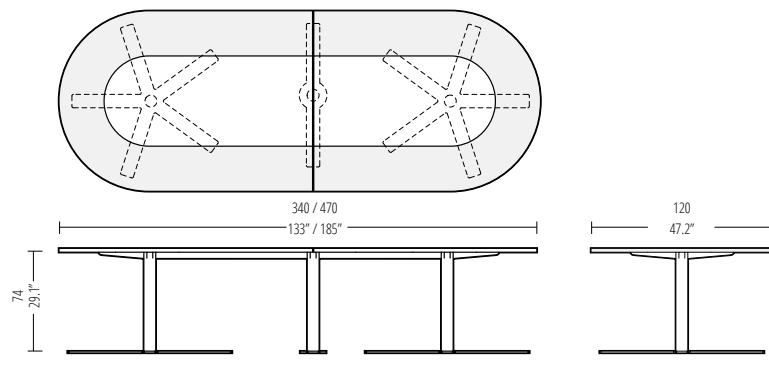



Blush Office Bold

SOLID	VENEER	HPL
 .000 natural oak oiled	 .V000 natural oak	 .HWH white
 .100 American walnut oiled	 .V017 white wash oak	 .HBL black
	 .V100 American walnut	 .HGR grey ral 9006

BASE COLOUR

 .WH white	 .BL black	 .GR grey ral 9006
 .SB sapphire blue	 .QG quartz grey	
 .LB light blue	 .PG pebble grey	

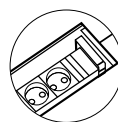
ACCESSORIES

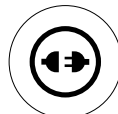
-  .SI socket integration
-  .QI wireless charging
-  .CM cable management



*Specifications are subject to change without prior notice.